

Valve plug MSC SuperSeal female with cable

PUR 2x0.75 bk 0.3m

Xtreme - Outdoor
Male straight
max. 24 V DC
2-pole
without components
without cable sleeves
Plastic housings with good resistance against chemicals and oils.
The resistance to aggressive media should be individually tested for your application. Further details on request.
Further cable lengths on request.

Link to Product

Illustration

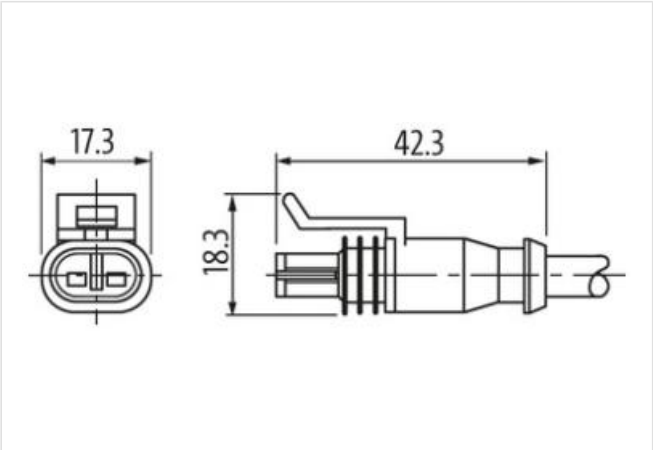
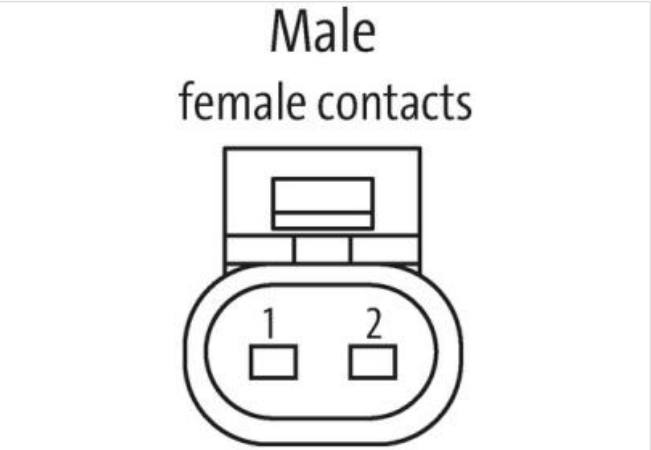
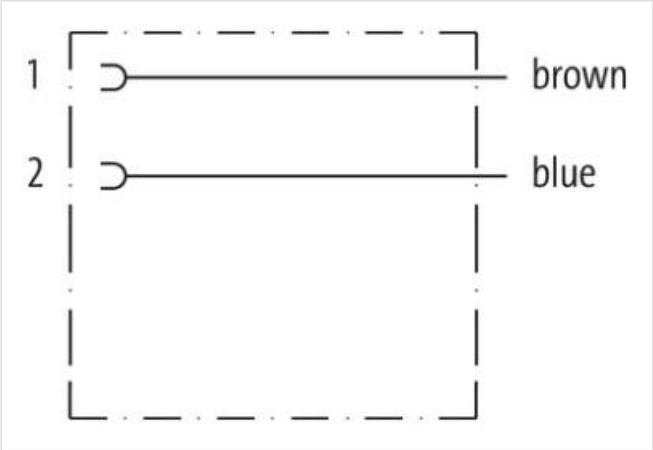

Product may differ from Image

| | |
|--------------------------|------------|
| Cable length | 0,3 m |
| Side 1 | |
| Mounting method | inserted |
| Coating contact | tin-plated |
| Family construction form | SuperSeal |

| | |
|-------------------------------------------------|-------------------------------------------------------------------------------------------------------------------------------------------------------|
| suitable for corrugated tube (internal Ø) | 11 mm |
| Material contact | Copper alloy |
| No. of poles | 2 |
| Commercial data | |
| ECLASS-6.1 | 27279218 |
| ECLASS-7.0 | 27279218 |
| ECLASS-8.0 | 27279218 |
| ECLASS-9.0 | 27060312 |
| ECLASS-10.1 | 27060312 |
| ECLASS-11.1 | 27060312 |
| ECLASS-12.0 | 27060312 |
| customs tariff number | 85444290 |
| GTIN | 4048879892414 |
| Packaging unit | 1 |
| Electrical data Supply | |
| Operating voltage DC max. | 24 V |
| Current operating per contact max. | 8 A |
| Diagnostics | |
| Status indication LED | no |
| Installation Connection | |
| Family construction form | AMP SuperSeal 1.5 |
| Device protection Electrical | |
| Degree of protection (EN IEC 60529) | IP67 |
| Additional condition protection degree | inserted, locked |
| Pollution Degree | 3 |
| Rated surge voltage | 1,5 kV |
| Additional suppressor | without components |
| Mechanical data Material data | |
| Color housing | black |
| Material gasket | Silicon |
| Material housing | Plastic |
| Material overmolding | PUR |
| Mechanical data Mounting data | |
| Looking techniques | Snap-in connector |
| Environmental characteristics Climatic | |
| Operating temperature min. | -40 °C |
| Operating temperature max. | 125 °C |
| Additional condition temperature range | depending on cable quality |
| Important installation notes | |
| Note on strain relief | Protect the connectors by suitable measures from mechanical loads, e.g. by the usage of cable ties. |
| Note on bending radius | Attention: Observe the permissible bending radii when laying cables, as the IP protection class can be endangered by excessive bending forces. |