

CAP BIG WITH PLUG. SCREW TERM. 21-POLE

For use with 4-,6-,8-way d-box M12 5-pole

Cap for 4-, 6-, and 8-way distribution box, 5-pole  
Screw plug-in terminals  
Plastic housings with good resistance against chemicals and oils.  
The resistance to aggressive media should be individually tested for your application. Further details on request.

Link to Product

Illustration

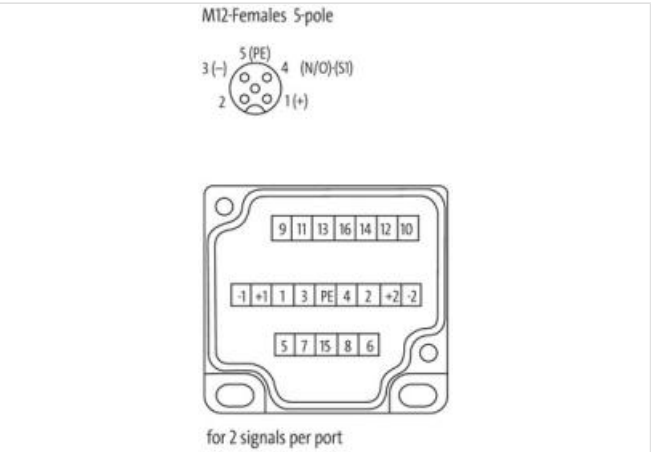
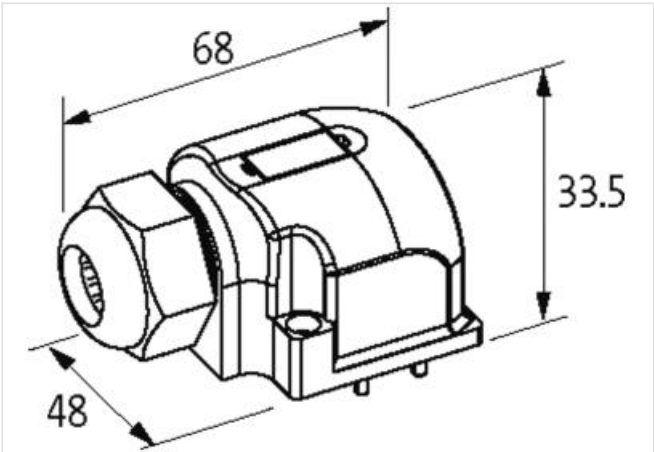

Product may differ from Image



Commercial data	
ECLASS-6.0	27143423
ECLASS-6.1	27279219
ECLASS-7.0	27279219
ECLASS-8.0	27279219
ECLASS-9.0	27440108
ECLASS-10.1	27440111

ECLASS-11.1	27440111
ECLASS-12.0	27440111
ETIM-5.0	EC002585
customs tariff number	85369010
GTIN	4048879300056
Packaging unit	1

**Electrical data | Supply**

Total current max.	8 A
--------------------	-----

**Installation**

Connection cross section max.	1,5 mm <sup>2</sup>
AWG number max.	16

**Installation | Connection**

Connection	Screw plug-in terminals
------------	-------------------------

**Device protection | Media**

Flame resistance	flame retardant
------------------	-----------------

**Mechanical data | Material data**

Material housing	Plastic
------------------	---------

**Environmental characteristics | Climatic**

Operating temperature min.	-20 °C
Operating temperature max.	80 °C

**Connection type 1**

Family construction form	Cap
No. of poles	21