

**B24 Surface mounted h., IP68**

Screw locking, side entry M40

B24

Surface mounted housing

Screw locking

IP68

Technical data will be only guaranteed with Murrelektronik components.

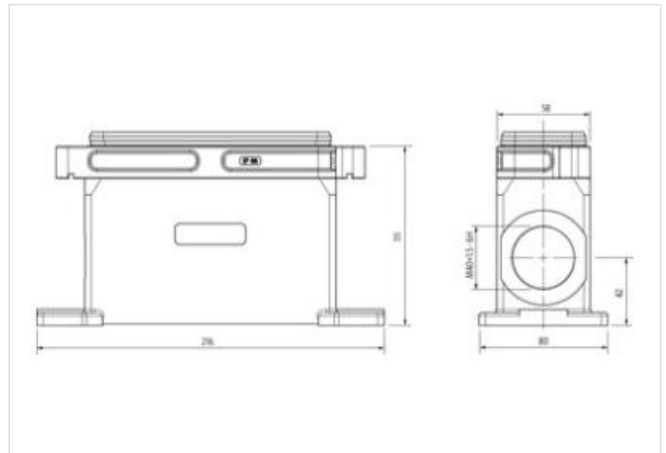
**[Link to Product](#)****Illustration**

Product may differ from Image

**Commercial data**

ECLASS-6.0	27143424
ECLASS-6.1	27261203
ECLASS-7.0	27440202
ECLASS-8.0	27440202
ECLASS-9.0	27440202
ECLASS-10.1	27440202
ECLASS-11.1	27440202
ECLASS-12.0	27440202
ETIM-5.0	EC000437
customs tariff number	85389099
GTIN	4048879647458
Packaging unit	1

**Installation**

Cable outlet	laterally
--------------	-----------

**Installation | Connection**

Mounting set	M40
Mating cycles min.	500

**Device protection | Electrical**

Degree of protection (EN IEC 60529)	IP68
Additional condition protection degree	inserted, locked, with screw connection

**Mechanical data**

Housing type	Surface mounted housing
--------------	-------------------------

**Mechanical data | Material data**

Coating housing	powder-coated
-----------------	---------------

Material gasket	Silicon
-----------------	---------

Material housing	Aluminum die casting
------------------	----------------------

Locking material	Stainless steel
------------------	-----------------

**Mechanical data | Mounting data**

Size	B24
------	-----

Mounting method	Screw locking
-----------------	---------------

Height	111 mm
--------	--------

Width	80 mm
-------	-------

Depth	216 mm
-------	--------

**Environmental characteristics | Climatic**

Operating temperature min.	-40 °C
----------------------------	--------

Operating temperature max.	125 °C
----------------------------	--------

Climatic category (EN IEC 60068-1)	40/125/21
------------------------------------	-----------