

CAP FOR D-BOX M12 8-WAY 5-POLE

No pot.-sep. 5m PUR/PVC-JB, 16x0,34+3x0,75

for 8-way distribution boxes, 5-pole
PUR/PVC
5.0 m

New Art.-No. 8000-88559-3980500

Plastic housings with good resistance against chemicals and oils.

The resistance to aggressive media should be individually tested for your application. Further details on request.

Link to Product

Illustration



Product may differ from Image

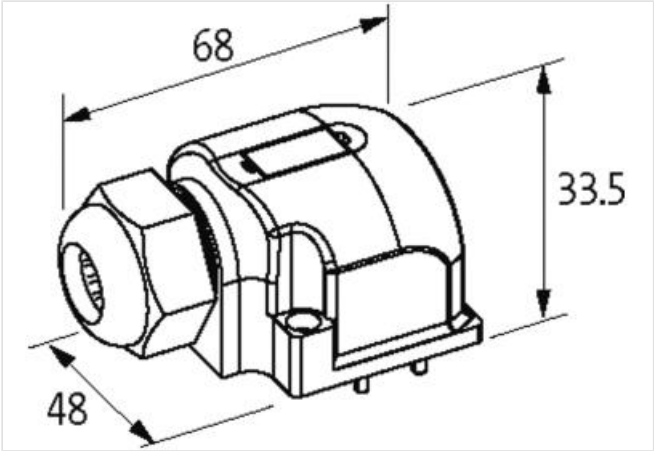

Commercial data

ECLASS-6.0	27143423
ECLASS-7.0	27449001
ECLASS-8.0	27449001
ECLASS-9.0	27440321
ETIM-5.0	EC002585
customs tariff number	85444290
GTIN	4048879058322
old articlenumber	8000-88559-3980500
Packaging unit	1

Electrical data | Supply

Total current max.	8 A
--------------------	-----

Mechanical data | Mounting data

Height	33 mm
Width	48 mm
Depth	68 mm

Installation | Cable

STOOW style jacket	Hybrid, Signal, Power
Cable identification	398
Cable Type	2
Jacket Color	gray
Type of Certificate	cURus
Amount stranding	1
Stranding	7 wires around Core filler twisted

Amount stranding (type 2)	1
Stranding (type 2)	12 wires around Stranding combination twisted
wire arrangement	white, gray-pink, brown-green, yellow, green-white, green, red-blue, (violet, brown-gray, black, gray-white, red, brown-yellow, pink, yellow-white, gray, blue, brown, green-yellow)
Cable weight	165 g/m
Material jacket	PUR
Shore hardness jacket	87 ± 5 Shore A
Freedom from ingredients (jacket)	lead-free, cadmium-free, CFC-free, silicone-free
Outer-diameter (jacket)	10 mm
Tolerance outer diameter (sheath)	± 5 %
Material inner jacket	PVC
Color (inner jacket)	gray
Material wire insulation	PVC
Amount wires	16
Outer diameter insulation	1,3 mm
Outer diameter tolerance core insulation	± 5 %
Shore hardness wire insulation	43 ± 5 Shore D
Material properties wire insulation	good machinability
Ingredient freeness wire insulation	lead-free, cadmium-free, CFC-free, silicone-free
Amount strands (wire)	19
Diameter of single wires	0,15 mm
Conductor crosssection (wire)	0,34 mm²
Traversing distance (C-track)	5 m @ 25 °C
Material conductor wire	Stranded copper wire, bare
Conductor type (wire)	Strand class 5
Travel speed (C-track)	3
Material wire insulation (Power)	PVC
Outer diameter wire insulation (Power)	1,8 mm
Tolerance outer diameter wire insulation (Power)	±5 %
Shore hardness wire insulation (Power)	43±5 Shore D
Material properties wire insulation (Power)	good machinability
Ingredient freeness wire insulation (Power)	lead-free, cadmium-free, CFC-free, silicone-free
Amount strands wire (Power)	42
Diameter of single wires (Power)	0,15 mm
Wire conductor cross section (Power)	0,75 mm²
Material conductor wire (Power)	Stranded copper wire, bare
Conductor type wire (Power)	strand class 6
Max. rated voltage (conductor - conductor)	300 V
Max. rated voltage (conductor - ground)	300 V
Current load capacity (standard)	to DIN VDE 0298-4
Current load capacity min. wire	4 A
Loop resistance	7,8 A
Electrical resistance line constant wire	57 Ω/km @ 20 °C
Electrical resistance coating wire (Power)	26 Ω/km @20 °C
AC withstand voltage (wire - wire)	2 kV @ 60 s
Power frequency withstand voltage (wire - jacket)	2 kV @ 60 s
Min. operating temperature (static)	-30 °C
Max. operating temperature (fixed)	80 °C
Operating temperature min. (dynamic)	-5 °C
Operating temperature max. (dynamic)	70 °C
Flame resistance	IEC 60332-2-2 UL 1581 § 1090 UL 1581 § 1100 FT2
chemical resistance	Good, application-related testing
Gasoline resistance	Good, application-related testing

Oil resistance	Good, application-related testing DIN EN 60811-404
----------------	--

Bending radius (fixed)	5 x Outer diameter
------------------------	--------------------

Bending radius (dynamic)	10 x Outer diameter
--------------------------	---------------------

Travel speed (C-track)	2 Mio. @ 25 °C
------------------------	----------------

Connection type 2

Family construction form	M12
--------------------------	-----

Gender	female
--------	--------

Color contact carrier	black
-----------------------	-------

Coding	A
--------	---

No. of poles	5
--------------	---

PIN 1	+
-------	---

PIN 2	NC S 2
-------	--------

PIN 3	-
-------	---

PIN 4	NO S 1
-------	--------

PIN 5	PE
-------	----

Connection type 1	X1-X8
-------------------	-------

Family construction form	free cable end
--------------------------	----------------

Color contact carrier	gray
-----------------------	------

No. of poles	19
--------------	----

Family construction form	M12
--------------------------	-----

Gender	female
--------	--------

Color contact carrier	black
-----------------------	-------

Coding	A
--------	---

No. of poles	5
--------------	---

PIN 1	+
-------	---

PIN 2	NC S 2
-------	--------

PIN 3	-
-------	---

PIN 4	NO S 1
-------	--------

PIN 5	PE
-------	----

Family construction form	free cable end
--------------------------	----------------

Color contact carrier	gray
-----------------------	------

No. of poles	19
--------------	----